



Kanca

ISUZU



DIAPHRAGMS / DİYAFLAMLAR



Fig. 1



Fig. 2



Fig. 3



Fig. 4



Fig. 5

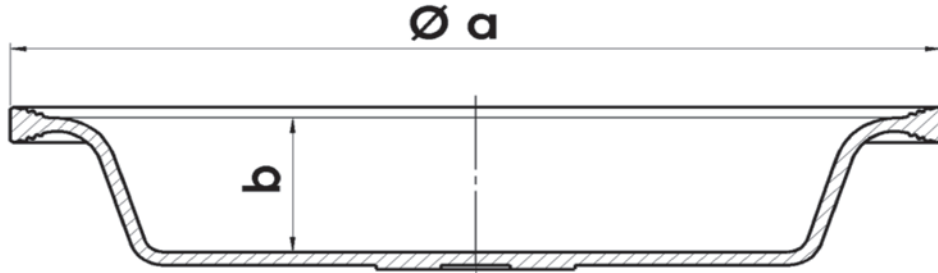

ÜRÜN KODU / PRODUCT CODE	ÜRÜN İSMİ / PRODUCT NAME	ŞEKİL / FIGURE	ÇAP / DIAMETER Ø a	DERİNLİK / DEPTH b
AA.10611	T.9 DİYAFLAM	Fig.1	129	25
AA.10610	T.12 DİYAFLAM	Fig.1	140	28
AA.10614	T.14 DİYAFLAM	Fig.1	145	30
AA.10608	T.16 DİYAFLAM	Fig.1	159	32
AA.10606	T.20 DİYAFLAM	Fig.1	168	32
AA.10604	T.24 DİYAFLAM	Fig.1	179	32
AA.10613	T.27 DİYAFLAM	Fig.1	201	34
AA.10603	T.30 DİYAFLAM	Fig.1	201	32
AA.10619	T.30 M DİYAFLAM	Fig.1	201	36
AA.10601	T.36 DİYAFLAM	Fig.1	224	42
AA.10617	T.9 LS DERİN DİYAFLAM	Fig.2	129	32
AA.10616	T.12 LS DERİN DİYAFLAM	Fig.2	140	34
AA.10612	T.14 LS DERİN DİYAFLAM	Fig.2	145	36
AA.10609	T.16 LS DERİN DİYAFLAM	Fig.2	159	44
AA.10607	T.20 LS DERİN DİYAFLAM	Fig.2	168	44
AA.10605	T.24 LS DERİN DİYAFLAM	Fig.2	179	44
AA.10615	T.27 LS DERİN DİYAFLAM	Fig.2	201	44
AA.10602	T.30 LS DERİN DİYAFLAM	Fig.2	201	44
AA.10620	T.36 LS DERİN DİYAFLAM	Fig.2	224	44
AA.10623	T.24 MEMELİ DİYAFLAM	Fig.3	179	32
AA.10622	T.30 MEMELİ DİYAFLAM	Fig.3	201	32
AA.10621	T.30 LS DERİN MEMELİ DİYAFLAM	Fig.3	201	47
AA.10624	T.12/16 DİYAFLAM	Fig.4	159	33
AA.10625	T.14/16 DİYAFLAM	Fig.4	159	33
AA.10627	T.16 S TİPİ DİYAFLAM	Fig.5	159	27
AA.10626	T.20 S TİPİ DİYAFLAM	Fig.5	170	25
AA.10628	T.24 S TİPİ DİYAFLAM	Fig.5	179	25

FOR OTHER TYPES OF BRAKE CHAMBER PLEASE CONTACT OUR COMPANY

Type	Ref. NR	O.E.M. NR	Araç / Vehicle
------	---------	-----------	----------------



BS0012 10005

12
STROKE
57

M16X1.5

Mil Boyu / Rod Length
27 mm

NQR KAMYON
2000 MODEL
SONRASI
NQR TRUCK
AFTER 2000
MODEL



BP1216 20465

12/16
D/P
STROKE
57/57

M22X1.5

Disk Boyu / Disc Length
15 mm

925 486 1100

NOVA



BP1216 20466

12/16
D/P
STROKE
57/57

M22X1.5

Disk Boyu / Disc Length
15 mm

925 486 1110

NOVA



BP1248 10401

12/4800
D/P
STROKE
44.5/44.5
M16X1.5

Mil Boyu / Rod Length
185 mm

ROYBUS
TURKUAZ
2008 MODEL
SAĞ/RIGHT

FOR OTHER TYPES OF BRAKE CHAMBER PLEASE CONTACT OUR COMPANY

Araç / Vehicle	O.E.M. NR	Ref. NR	Type
----------------	-----------	---------	------

ROYBUS
TURKUAZ
2008 MODEL
SOL/LEFT

12/4800

D/P

STROKE
44.5/44.5
M16X1.5

Mil Boyu / Rod Length
185 mm



BP1248 10402

ROYBUS-C
2008 MADEL
SAĞ/RIGHT

12/4800

D/P

STROKE
44.5/44.5
M16X1.5

Mil Boyu / Rod Length
36 mm



BP1248 10453

ROYBUS-C
2008 MADEL
SOL/LEFT

12/4800

D/P

STROKE
44.5/44.5
M16X1.5

Mil Boyu / Rod Length
36 mm



BP1248 10454

**ŞAFT ASKI TAKIMLARI
SHAFT CENTER SUPPORT BEARING**

Araç / Vehicle

Ref. NR

Açıklama
Description

NPR. 4.8
NPR. 4.3

Ø : 40 HC : 168,4

W : 27 H : 65



AB. 20480